

**POP™ MODE ALERTS**

**POP™ Mode Alerts**  
Because POP™ Mode travels on regular radar bandwidth, there is no particular alert for POP™ Mode transmissions. POP™ Mode alerts will be displayed as a regular radar alert.

**LASER/RADAR ALERTS**

**Speed Radar Audio/Visual Alerts**  
When X, K or Ka is detected, the band ID and signal strength is displayed. The audio alert is continuous and has a geiger counter-like pattern. The faster the beep, the closer or stronger the radar source.

**Laser Audio/Visual Alerts**  
When a laser signal is detected the audio alert is continuous for a minimum of 3 seconds.  
• The Displays Shows: The more "lll" the closer the laser source.

**Pulse Protection®**  
Pulse (or instant-on) radar is more difficult to detect than conventional radar because it remains 'off' until activated to measure the speed of a targeted vehicle. When a pulse type transmission is detected, your Whistler detector sounds an urgent 3-second audio warning and the display shows: 'PULSE'

After the 3-second pulse alert, the standard alert pattern continues for as long as the signal is present. It is important to respond promptly to a pulse alert, since warning time may be minimal.

14

**SPEED MONITORING**

**Laser Tips**  
If you are the targeted vehicle, a laser gun can often determine your speed within a few seconds after you receive an alert. In this situation there is generally no time to safely adjust your speed. However, if you are traveling near or behind the targeted vehicle and receive an alert, response time should be sufficient. Any laser alert, regardless of duration, requires immediate action!

**Other Speed Detection Systems**  
Several techniques other than radar or laser are used to measure vehicle speeds. When these methods are being used, no detector can provide a warning. These techniques include:

- **Pacing** - A patrol car drives behind you and matches your driving speed.
- **Vascar/Aircraft** - The time it takes a vehicle to travel a known distance is measured.

**Radar Detector Detectors: VG-2, Spectre**  
The Interceptor VG-2, or simply VG-2, is one type of microwave receiver used by Police to detect signals radiated by the local oscillator of a radar detector. Because its purpose is to identify persons driving with radar detectors, these devices are known as a "radar detector detector" (RDD). An RDD is the primary tool used by the police to identify radar detectors equipped vehicles. If caught in a state or country where detectors are illegal, (see page 18), drivers risk losing their radar detector and receiving a fine. In addition, instant-on radar is almost always used in combination with a RDD, leaving unsuspecting motorists vulnerable to receive two tickets - one potential for speeding, the other for possession of a detector.

21

**VG-2 ALERTS**

**VG-2 Audio/Visual Alerts**  
**NOTE:** You must turn this feature on before it will detect VG-2.  
When a VG-2 signal is detected, the detector 'hides' its own radiated signal and becomes undetectable by the VG-2. Every 30 seconds, the detector checks for a VG-2 signal. If a VG-2 signal is still present, the unit continues to hide and repeats the VG-2 alert. If no signal is detected, two beeps are provided, indicating an 'all clear' condition. During a VG-2 Alert X, K, and Ka band signals cannot be received (Reference page 21 for VG-2 information).

**Alert Priority**  
When two or more signals are received at the same time, the alert priority is:  
1. Laser  
2. VG-2  
3. Speed Radar  
4. Safety Radar

**Example:**  
If X band is alerting, then suddenly a VG-2 signal is detected, the VG-2 warning will override the X band alert.

15

**SPEED MONITORING**

**NOTE:** Having a radar detector capable of detecting the VG-2 may alert you to the presence of a speed trap. The newest tool Police have to detect radar detectors is called Spectre. As of this printing, Spectre can detect all undetectable (VG-2) laser/radar detectors on the market.

It is the responsibility of the individual radar detector owner to now and understand the laws in your area regarding the legality of the use of radar detectors.

**WARRANTY INFORMATION**

**Consumer Warranty**  
This Whistler Laser-Radar detector is warranted to the original purchaser for a period of one year from the date of original purchase against all defects in materials and workmanship. This limited warranty is void if the unit is abused, modified, installed improperly, if the housing and/or serial numbers have been removed. There are no express warranties covering this product other than those set forth in this warranty. All express or implied warranties for this product are limited to the above time. Whistler is not liable for damages arising from the use, misuse, or operation of this product.

22

**RESET FEATURES**

**Reset Features**  
All user features can be reset to factory settings.  
• Unplug Power Cord from unit.  
• Press and hold Power and Quiet.  
• Plug Power Cord into unit.  
• Wait for 2 beeps.  
• Release Power and Quiet buttons.

**Unit is now reset to the following features and settings.**

- Default factory settings are:**
1. Audio to level (4).
  2. Display reads Highway.
  3. Dim/Dark Mode to full illumination of display.
  4. Auto Quiet Mode OFF.
  5. VG-2 Detection Mode OFF.
  6. Safety Radar OFF.
  7. Vehicle Battery Saver ON.
  8. Full Power Up sequence.
  9. Default TONE 3.
  10. POP ON.
  11. Voice On (1778 only).
  12. DAD set to ALL (1776 only)

16

**WARRANTY INFORMATION**

**Service Under Warranty**  
During the warranty period, defective units will be repaired without charge to the purchaser when returned with a dated store receipt to the address below. Units returned without a dated store receipt will be handled as described in section "Service Out Of Warranty." Due to the specialized equipment necessary for testing a Laser-Radar receiver, there are no authorized service stations for Whistler brand detectors other than Whistler.

When returning a unit for service under warranty, please follow these instructions:

1. Ship the unit in the original carton or in a suitable sturdy equivalent, fully insured, with return receipt requested to:

**Whistler Repair Dept.**  
1201 North Dixieland Rd  
Rogers, AR. 72756

**Please allow 3 weeks turnaround time.**

**IMPORTANT:** Whistler will not assume responsibility for loss or damage incurred in shipping. Therefore, please ship your unit insured with return receipt requested. **CODs will not be accepted!**

2. Include with your unit the following information, clearly printed:
  - Your name and street address (for shipping via UPS), a daytime telephone number and an email address, if applicable.
  - A detailed description of the problem (e.g., "Unit performs self-test but does not respond to radar").
  - A copy of your dated store receipt or bill of sale.

23

**TROUBLESHOOTING**

Your Whistler detector is expertly engineered and designed to exacting quality standards to provide you with reliable, trouble-free operation. If your unit has been correctly installed following the guidelines in this manual, but is not operating optimally, please refer to the troubleshooting guide below.

**PROBLEM: No display or audio.**  
• Check fuse in Whistler plug; replace if necessary with a 2 amp 3AG type.  
• Check fuse for lighter socket; replace if necessary.  
• Make sure lighter socket is clean.

**PROBLEM: Unit alarms when vehicle hits bumps.**  
• Check for loose lighter socket; tighten and clean.  
• Check connections at both ends of power cord. Substitute another cord to determine if cord is defective. Return defective cord to the factory.

**PROBLEM: Unit alarms when using vehicle electrical accessories (brakes, power mirrors, power windows, turn signals, horn, etc.).**  
• Vehicle's electrical system, including battery and alternator, may have electrical noise. Install a filter capacitor (470mfd. 25 volt or larger capacitance value) on the back of the lighter socket.

**PROBLEM: Unit gives laser alert when accelerating.**  
• Possible bad or low quality distributor cap. Replace with high quality cap.

**PROBLEM: Audio alerts are not loud enough.**  
• Cancel Auto Quiet Mode or City Mode.  
• Check audio level setting (see page 7 & 8).

If difficulties occur which cannot be solved by information in this Troubleshooting Guide, please call Whistler Customer Service at 1-800-531-0004 or visit our FAQ page at [www.whistlergroup.com/faq-detectors.asp](http://www.whistlergroup.com/faq-detectors.asp), before returning your unit for service.

17

**WARRANTY INFORMATION**

3. Be certain your unit is returned with its serial number. For reference, please write your unit's serial number in the following space: s/n\_\_\_\_\_.

Units without serial numbers are not covered under warranty.

**IMPORTANT: To validate that your unit is within the warranty period, make sure you keep a copy of your dated store receipt. You may register your warranty online at [www.whistlergroup.com](http://www.whistlergroup.com), however, for warranty verification purposes, a copy of your dated store receipt must accompany any unit sent in for warranty work.**

**Service Out of Warranty**  
Units will be repaired at 'out of warranty' service rates when:  
• The units original warranty has expired.  
• A dated store receipt is not supplied.  
• The unit has been returned without its serial number.  
• The unit has been abused, modified, installed improperly, or had its housing removed.

The minimum out of warranty service fee for your Whistler detector is \$55.00 (U.S.). If you require out of warranty service, please return your unit as outlined in the section "Service Under Warranty" along with a certified check or money order for \$55.00. Payment may also be made by MasterCard, VISA or American Express; **personal checks are not accepted.**

**In the event repairs cannot be covered by the minimum \$55.00 service fee, you will be contacted by a Whistler technical service specialist who will outline options available to you.**

If you elect not to have your unit repaired, it will be returned to you along with your certified check or money order.

24

**CARE AND MAINTENANCE**

**Care And Maintenance**  
During the summer months, avoid prolonged exposure to direct sunlight by removing your unit from the dash when your vehicle is parked for an extended period of time. Do not spray water, cleaners, or polishes directly onto the unit. The spray may penetrate through the openings and damage the unit. Also, do not use any abrasive cleaners on the unit's exterior.

**ARE DETECTORS LEGAL?**

**In Most States YES!**  
Laser-Radar detectors are legal in every state (with the exception of Virginia and Washington, D.C., which have local regulations restricting the use of radar receivers in any vehicle) when used in automobiles or light trucks (under 10,000 lbs.).

Concerning trucks over 10,000 lbs., the Federal Highway Administration (FHWA) issued a regulation, effective January, 1994 which prohibits radar and laser detector use in these types of vehicles nationally. Prior to the FHWA regulation, laws existed in the state of New York restricting the use of radar detectors in trucks over 18,000 lbs. and in Illinois in trucks over 26,000 lbs.

18

**WARRANTY INFORMATION**

**IMPORTANT:** When returning your unit for service, be certain to include a daytime telephone number and email address (if applicable).

**Customer Service**  
If you have questions concerning the operation of your Whistler detector, or require service during or after the warranty period, please call Customer Service at: **1-800-531-0004**  
Representatives are available to answer your questions Monday - Friday from 8:00 a.m. to 5:00 p.m. (CT) or visit the FAQ's at [www.whistlergroup.com](http://www.whistlergroup.com).

**SPECIFICATIONS**

**Dimensions:** 4.65" L x 2.95" W x 1.45" H  
**Weight:** 1776 - 6.02 oz., 1778 - 6.3 oz.  
**Laser Wavelength:** 905 ± 50 nanometers (nm)  
**Radar Frequencies:** 10.500 - 10.550 GHz (X Band)  
24.050 - 24.250 GHz (K Band)  
33.400 - 36.000 GHz (Ka Superwideband)  
**Operating Temperature Range:** -20° C to +80° C (-4° F to +176° F)  
**Power Requirements:** Operational 12 to 15 volts DC, 250mA nominal  
Vehicle Battery Saver, 30mA nominal.  
**One or more U.S. patents may apply:** #5,146,227, #5,379,456, #5,666,120, #5,990,821

POP™ Mode is a trademark of MPH Industries, Inc. Specifications are subject to change without notice.

25

**FCC INFORMATION**

**FCC ID : HSXWH11**  
This device complies with part 15 of the FCC Rules. Operation is subject to the following two conditions:  
(1) This device may not cause harmful interference, and  
(2) this device must accept any interference received, including interference that may cause undesired operation.

**IMPORTANT**  
FCC requirements state that changes or modifications not expressly approved by Whistler could void the user's authority to operate the equipment.

**SPEED MONITORING**

**Radar Facts**  
A radar gun operates by transmitting radio waves at certain frequencies which reflect off objects and are picked up by the radar gun's receiving section. When a radar beam reflects off a moving target, a measurable frequency shift occurs. The radar unit converts this shift into miles per hour to determine your vehicle's speed. Currently, the FCC (Federal Communications Commission) permits operation of traffic radar guns at X Band (10.500 - 10.550 GHz), K Band (24.050 - 24.250 GHz), and Ka Band (33.400 - 36.000 GHz).

**Note:** A radar detector will not alarm if an officer is not transmitting on any one of the above radar bands.

**POP™ Mode**  
POP™ Mode is a feature on some newer radar guns operating on K and Ka bands. When the gun is in POP™ Mode and activated, a brief burst of energy, less than 1/15 of a second, is transmitted and the vehicle's speed is quickly acquired. A detector without POP™ Mode detection capability cannot respond to this brief transmission.

19

**ACCESSORIES**

These and other accessories can be ordered directly from Whistler by calling 1-800-531-0004 or by visiting our online store at [www.whistlergroup.com](http://www.whistlergroup.com)

Order Code	Description	Price
403774	Intell-Cord™	\$ 27.95
202151	Windshield Bracket Kit	\$ 9.95
206552	Straight Power Cord (5')	\$ 14.95
206553	Coiled Power Cord (7')	\$ 15.95
206880	Hardwire Kit (10') (for wiring to fuse box)	\$ 9.95
206666	Modular Cord Package (includes coiled and straight cords, and power adapter)	\$ 17.95
159032	Package of 8 Suction Cups	\$ 2.95
402081	Non-Skid Dash Pad	\$ 6.95
206660	Straight Modular Cord and Socket Multiplier	\$ 11.95
206661	Coiled Modular Cord and Socket Multiplier	\$ 12.95

\*Modular: Interconnecting pieces cord and plug. Shipping and handling (per order) \$7.50 Prices are subject to change without notice.

26

**SPEED MONITORING**

**Total Band Protection™**  
Complete Band Coverage that detects laser, radar, VG-2 and safety radar bands.

**Laser Facts**  
It's well documented that many radar guns cannot reliably provide the speed of a targeted vehicle that is traveling in a group of vehicles. In contrast, a laser gun can target a specific vehicle out of a line of traffic and determine its speed. The advantage of laser over radar in terms of target identification is the result of the laser gun's narrow beam. A radar gun's transmission can cover more than a four-lane highway at a distance of 1,000 feet, compared with a laser gun's transmission which covers about 3 feet at the same distance. For best protection, keep these points in mind:

- Because the vehicle's license plate or headlights are the laser gun's primary targets, mounting the Whistler detector on the dashboard can improve laser detection at short range.
- Do not follow closely behind any vehicle you cannot see through. If you can't see past a vehicle ahead of you, chances are your detector won't either.
- The receiving range of your laser detector will not be the same as a radar detector. Laser guns are most often used at short range.

Whistler Laser-Radar detectors receive all current laser guns which operate at a laser wavelength of 905 +/- 10mm.

- Pro Laser™ I II III
- LT1 20-20
- Ultra Lyte

20

**OWNER'S MANUAL**

**1776/78**  
**Total Band Protection™**  
**LASER-RADAR**  
**DETECTOR**



**The Whistler Group Corporate Headquarters**  
13016 N. Walton Blvd. • Bentonville, AR 72712  
Tel 479.273.6012 • Fax 479.273.2927

**Customer Return Center**  
1201 N. Dixieland Rd. • Rogers, AR 72756  
Customer Service Tel 800.531.0004  
[www.whistlergroup.com](http://www.whistlergroup.com)

P/N 203348, © 2005 The Whistler Group, Inc.



26



If you have questions concerning the operation of this Whistler product please call:

**CUSTOMER SERVICE**  
**1-800-531-0004**

Monday - Friday • 8:00 am - 5:00 pm CT

or visit our website

**www.whistlergroup.com**

Please keep the receipt in a safe place. You may register your product online at [www.whistlergroup.com](http://www.whistlergroup.com). For warranty verification purposes, a copy of your dated store receipt must accompany any unit sent in for warranty work. If the unit is returned without a dated store receipt, an out of warranty service charge applies. **Note:** Your warranty period begins at the time of purchase. The warranty is validated **only** by the dated store receipt! Now is the time to record the serial number of the unit in the space provided in the warranty section of the manual.

## OPERATION

### Power On and Self-Test

Each time your Whistler detector is turned on, an automatic self-test sequence confirms that the speaker and visual displays are functional.

- Press Power. Display shows in order:  
1. WHISTLER 2. X-band 3. K-band 4. Ka-band  
5. LASER 6a. Voice ON (1778 Only) 6b. SR OFF  
7. VG2 OFF 8. POP ON 9. B.SVR ON 10. HWY

### Setting Saver

Setting Saver saves your personalized settings so that when the detector is turned off and then on again, you do not have to re-enter them.

### Feature Engaged Confirmation

Each time a button is pressed one beep confirms feature "on", two beeps confirm feature "off".

### Audio Level Adjustment

The audio levels can be adjusted high to low or low to high.

- Press Volume up to increase audio level.
- Press Volume down to decrease audio level.

As audio level is adjusted, beeps are provided and the display indicates volume level.

### Integrated Real Voice® (1778 Only)

When selected, Real Voice® will be used to articulate the following:

1. Band Identification
2. Safety Warning System messages
3. Feature Selection

**NOTE:** In certain cases the voice message does not replicate the text message.

## INTRODUCTION

Dear Whistler Owner,

With the change in time also comes change in technology. Radar gun manufacturers have stepped up to the plate. The new arsenal they carry is called POP™ Mode. This new gun is a normal K or Ka band radar gun detectable by most radar detectors made in the past 30 years, unless the gun is placed in POP™ Mode. POP™ Mode is a feature on some newer radar guns operating on K and Ka bands. When the gun is in POP™ Mode and activated, a brief burst of energy, less than 1/15 of a second, is transmitted and the vehicle's speed is quickly acquired. A detector without POP™ Mode detection capability cannot respond to this brief transmission. This detector has the power to report this new gun where other detectors cannot!

Whistler introduces the 1776 and 1778 with POP™ Mode detection! These units are the beginning in total protection. With POP™ Mode detection, these units can react fast enough to detect this new technology. Packed with power you still have a full featured radar detector:

- **Intense Blue Text Display** provides distinct visual confirmation of signals detected, signal strength, and indicates engaged modes of operation.
- **Intelli-Cord™** provides remote access to two programmable features with the optional Intelli-Cord™.
- **Real Voice® Alerts (1778 Only)** are given verbally through the detector so you do not have to take your eyes off the road to look at the display.
- **Dual Alert Display: D.A.D (1776 Only)** provides added visual alerts of threats ahead.
- **Auto Dim (1778 Only)** automatically adjusts the display brightness for the surrounding light condition.

Even though these units are packed full of features, they're still very easy to use. To fully utilize your unit to its potential, we recommend reading this entire manual or visit our FAQ page on our web site [www.whistlergroup.com](http://www.whistlergroup.com).

Enjoy your new Whistler and please drive safely. Sincerely,

The Whistler Group, Inc.

## OPERATION

### Auto Quiet Mode

Auto Quiet reduces the selected audio level to level (1) approximately 5 seconds after a radar or safety radar signal is detected. The alert for any new signal within 20 seconds will resume at level (1). Auto Quiet does not affect VG-2 or laser alerts.

- Press Quiet/Menu (before a signal is detected) to engage Auto Quiet.
- Once the Auto Quiet mode is engaged, you may cancel the audio alarm by pressing Quiet.
- Press Quiet (when the unit is not alarming) to cancel Auto Quiet mode.

### Quiet Mode

Quiet cancels audio during an alert and any new alert within 20 seconds. After 20 seconds, approximately 2 beeps are provided on any new alert and unit then remains quiet.

- Press Quiet to cancel the audio.
- Press Quiet a second time during an alert to restore the standard audio alert pattern; or turn the unit off, then on.

### City/City 1/City 2 Mode

Whistler's Three Stage City Mode is designed to reduce the annoyance of automatic door openers, intrusion alarms and other devices which share frequencies with police radar. Generally, X band is used for these devices.

- Press City to cancel Highway mode and engage City.
- Press City a second time engages City 1.
- Press City a third time engages City 2.
- Pressing City a fourth time cancels City 2 Mode and returns the unit to Highway Mode.

## TABLE OF CONTENTS

<b>Model Features Summary.....</b>	<b>3 - 5</b>
<b>Installation.....</b>	<b>5 - 6</b>
• Mounting Guidelines.....	5 - 6
• Windshield Mounting.....	5 - 6
• Power Connection and Fuse Replacement.....	6
<b>Operation.....</b>	<b>7 - 13</b>
• Power On and Self-Test.....	7
• Setting Saver.....	7
• Feature Engaged Confirmation.....	7
• Audio Level Adjustment.....	7
• Integrated Real Voice®.....	7
• Auto Quiet Mode.....	8
• Quiet Mode.....	8
• City/City 1/ City 2 Mode.....	8 - 9
• Highway Mode.....	9
• Dim/Dark Mode.....	9
• Auto Dim (1778 Only).....	9
• Engaging/Disengaging VG-2.....	10
• Teach/Tutorial Mode.....	10
• Intelli-Cord™.....	10
• Option Select Mode.....	11
• Vehicle Battery Saver Mode.....	12
• Stay Alert Feature.....	12
<b>Safety Warning System™.....</b>	<b>13</b>
<b>POP™ Mode Alerts.....</b>	<b>14</b>
<b>Laser/Radar Alerts.....</b>	<b>14</b>
• Speed Radar Audio/Visual Alerts.....	14
• Laser Audio/Visual Alerts.....	14
• Pulse Protection®.....	14
<b>VG-2 Alerts.....</b>	<b>15</b>
• Alert Priority.....	15
<b>Reset Features.....</b>	<b>16</b>
<b>Troubleshooting Guide.....</b>	<b>17</b>
<b>Care and Maintenance.....</b>	<b>18</b>
<b>Are Detectors Legal?.....</b>	<b>18</b>
<b>FCC Information.....</b>	<b>19</b>
<b>Speed Monitoring.....</b>	<b>19 - 22</b>
• Radar Facts.....	19
• POP™ Mode.....	19
• Total Band Protection™.....	20
• Laser Facts.....	20
• Other Speed Detection Systems.....	21
<b>Warranty Information.....</b>	<b>22 - 25</b>
<b>Specifications.....</b>	<b>25</b>
<b>Accessories.....</b>	<b>26</b>

## WHISTLER FEATURES

### Feature Listings of 1776 and 1778

- |  |  |
|--|--|
| <ul style="list-style-type: none"> <li>• Total Band Protection™</li> <li>• POP™ Mode Detection</li> <li>• Intense Blue Text Display</li> <li>• Dual Alert Display</li> <li>• High Gain Optical Lens</li> <li>• Stay Alert™</li> <li>• 360° Total Perimeter Protection™</li> <li>• VG-2 Cloaking™ Technology</li> <li>• 3 City Modes</li> <li>• Quiet/Auto Quiet Modes</li> <li>• Vehicle Battery Saver</li> <li>• Setting Saver</li> <li>• Alert Priority</li> <li>• Safety Warning System™</li> </ul> | <ul style="list-style-type: none"> <li>• Total Band Protection™</li> <li>• POP™ Mode Detection</li> <li>• Real Voice® Alerts</li> <li>• Intense Blue Text Display</li> <li>• Auto Dim Display</li> <li>• High Gain Optical Lens</li> <li>• Stay Alert™</li> <li>• 360° Total Perimeter Protection™</li> <li>• VG-2 Cloaking™ Technology</li> <li>• 3 City Modes</li> <li>• Quiet/Auto Quiet Modes</li> <li>• Vehicle Battery Saver</li> <li>• Setting Saver</li> <li>• Alert Priority</li> <li>• Safety Warning System™</li> </ul> |
|--|--|

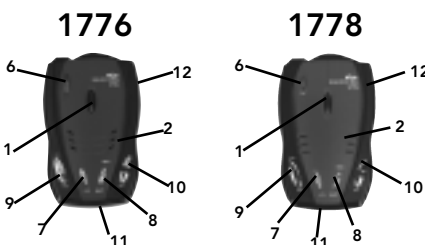

**Accessories:**  
Straight Power Cord, Hardwire Kit, & Windshield Bracket

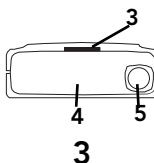

## OPERATION

### Auto Dim (1778 Only)

The Auto Dim feature automatically switches the illumination of the text display between the bright and dim settings according to varying light conditions so that the text display will always be easy to read. To manually override the auto dim feature, use the power/dim/dark button on the unit. Manual override is canceled when the unit is turned off. Enter option mode to turn off the auto dim feature.

### Engaging/Disengaging VG-2

See option select mode to turn this feature on/off. When a VG-2 signal is detected, the VG-2 alert is sounded. After 3 seconds the audio is cancelled and the VG-2 indicator flashes at a slower rate. This cycle is repeated if the VG-2 signal is again detected.

During the period a VG-2 signal is detected, a radar signal cannot be detected. However, because the VG-2 alert has confirmed that a patrol car is nearby, you are already aware of the potential for speed monitoring and can adjust your speed accordingly. Laser detection is not affected while a VG-2 signal is detected.

### Teach/Tutorial Mode

Provides simulated alerts for each type of signal.

- Press City and Quiet simultaneously and release.
- Display Shows: (TEACH)
- Press Power to exit.

### Intelli-Cord™

Using Whistler's optional Intelli-Cord™ Power Cable allows some models to control the detector's features such as Power On/Off, City Modes, Dim/Dark, and Quiet/Auto Quiet with a simple press of the button on the Power Cable. Two features can be controlled: one by a short press of the button, and the second by a long press of the button. Option Mode allows the user to program the feature assignments.

## FEATURE DESCRIPTIONS

Whistler's ergonomic and user-friendly design provides a new level of operating convenience. Special features include: **Note: Not all units have all features listed.**

1. **Bracket Release Button** – Provides quick and easy release of the mounting bracket.
2. **Speaker** – Provides distinct audio warnings for X, K, Ka band radar, safety radar, laser and VG-2.
3. **Mounting Bracket Location** – Slot holds mounting bracket firmly.
4. **Radar Antenna** – Compact, high-efficiency antenna receives radar signals.
5. **Front Laser Antenna** – High gain optical lens provides increased sensitivity and field of view for leading-edge laser detection.
6. **Rear Laser Antenna** – An integrated optical wave-guide provides superior detection of laser signals transmitted from behind.
7. **City Button** – Reduces the annoyance of false alerts typically encountered in urban driving areas.
8. **Quiet/Menu Button** - Pressing QUIET before a signal is detected engages Auto Quiet Mode which automatically reduces the audio level after the initial warning to a low audio level setting. Pressing QUIET during a radar/laser encounter silences audio alerts, while allowing visual alerts to keep you informed. (Pressing and holding for 2 seconds allows you to enter Option Select Mode—see page 11).
9. **Power/Dim Dark** - Turns unit on/off and engages Dim/Dark modes (press and hold for 2 seconds).
10. **Volume Up/Down Buttons** – Adjust volume up or down.
11. **Intense Blue Text Display** – Provides distinct visual confirmation of signals detected, signal strength, and indicates engaged modes of operation.
12. **Power Jack** – Provides connection for the power cord.
13. **Dual Alert Display: D.A.D (1776 Only)** provides added visual alerts of threats ahead.

## OPERATION

### Option Select Mode

Entering Option Select Mode allows you to customize options such as Tone Select, Abbreviated Power Up Sequence and VG-2 Mode. Press and hold quiet button to enter option Select mode. When selecting options, the or or quiet must be pressed within 20 seconds or options mode will automatically be exited. To enter:

Press Quiet:	Display Shows:	To Change:	Option:
For 2 Seconds	S1: POWER	OR	Remote Control of Dim, City, Quiet, Power Functions
2nd Time	S2: CITY	OR	Remote Control of Dim, City, Quiet, Power Functions
3rd Time	DAD: ALL (1776 Only)	OR	Selects All, 3 Seconds or Off
3rd Time	ADIM: ON (1778 Only)	= ON = OFF	Auto Dim On Auto Dim Off
4th Time	X-ON	= ON = OFF	X Band On X Band Off
5th Time	K-ON	= ON = OFF	K Band On K Band Off
6th Time	Ka-ON	= ON = OFF	Ka Band On Ka Band Off
7th Time	LASER ON	= ON = OFF	Laser Band On Laser Band Off
8th Time	TONE 3	= ON = OFF	Tone 1, 2, 3 (Three Different Tone Patterns)
9th Time	TEST ON	= ON = OFF	X, K, Ka Auto Tones One Beep During Power Up
10th Time	VG2 OFF	= ON = OFF	Turns VG-2 On Turns VG-2 Off
11th Time	SR OFF	= ON = OFF	Turns Safety Radar On Turns Safety Radar Off
12th Time	VOICE ON (1778 Only)	= ON = OFF	RealVoice Engaged RealVoice Disengaged
13th Time	POP ON	= ON = OFF	Pop On Pop Off
14th Time	B SVR ON	= ON = OFF	Battery Saver On Battery Saver Off

## FEATURE DESCRIPTIONS

14. **Auto Dim (1778 Only)** automatically adjusts the display brightness for the surrounding light conditions.

## INSTALLATION

### Mounting Guidelines

- Mount the unit as low as possible near the center of the windshield.
- Do not mount your unit behind wipers, ornaments, mirrored sunscreens, etc. These obstructions have metal surfaces which can affect radar and laser signals and reduce critical warning time. (Regular tinted glass does not affect reception.)
- Some windshields have an Instadclear™ or Electricear™ type coating, which affect radar signals. Consult your dealer or the owner's manual supplied with your vehicle to determine if your windshield has this coating.
- Avoid placing unit in direct contact with windshield.
- To reduce the possibility of theft, conceal your unit when not in use.

### Windshield Mounting

- Install the two suction cups and rubber bumper onto the bracket by fitting them into their holes.
- Press the suction cups onto the windshield at the location you have chosen. **IMPORTANT:** Some newer cars have a plastic safety coating on the inside of the windshield. The windshield bracket may leave permanent marks on this type of surface. To find out if your vehicle has this type of windshield, check the owner's manual or ask your dealer. We recommend that you do not leave the suction cup bracket on the window in direct sunlight.

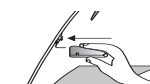

## OPERATION

### Vehicle Battery Saver Mode

The Vehicle Battery Saver Mode automatically shuts off your detector within 3 hours if you forget to turn it off. The timer is reset if the detector is turned off, unplugged or any button is pressed before the 3 hours have expired. The detector will alert you with an audible and visual warning before it shuts off.

During this warning you can reset the time by pressing any button.

If the unit has automatically turned itself off, press the Power button to turn the unit back on. You can manually engage the Vehicle Battery Saver Mode by pressing and holding the City button until one beep is heard.

Refer to "Option Select Mode" for instructions for deactivating battery saver mode feature.

### Stay Alert Feature

The Stay Alert Feature is designed to test a driver's alertness. To engage (when unit is not alarming) :

- Press and hold City for approximately 2 seconds. Release button during or immediately after the alert is given.

— Display shows: (RU ALERT)

Within 30-60 seconds two beeps are sounded; to show alertness, the driver must press either the City, Volume, or Quiet buttons within 3-5 seconds. If a button is pressed within 3-5 seconds, the cycle is repeated.

If a button was not pressed within 3-5 seconds alarm sounds and the display shows: (GET REST)

- Press Power to exit.

## INSTALLATION CONT.

### Windshield Mounting (Cont.)

- If the detector is removed, this may cause blistering of the dash in some vehicles.
  - Slide the detector onto the bracket until it locks into place.
  - If necessary, the unit may be leveled by bending the windshield bracket. Press the bracket release button and remove the detector before bending.

### Power Connection

- Plug the small end of the power cord into the unit's power jack.
- Plug the large end into the vehicle's cigarette lighter.

**NOTE: Cord fits tightly into detector. When installing the cord, expect some resistance.**

### Fuse Replacement

The lighter socket plug is equipped with a replaceable 2 amp 3AG fuse located behind the silver tip. To replace the fuse, carefully unscrew the tip of the plug. **IMPORTANT: Unscrew slowly. The tip contains a spring which may fly out when disassembling.** Insert the new fuse with the spring and screw on the tip. **With use, screw cap on plug may loosen. Retighten occasionally.**

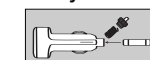

Unscrew the tip of the lighter socket plug carefully when replacing the 2 amp fuse.

## OPERATION

### Stay Alert Feature (Cont.)

**WARNING!!!** Stay Alert is NOT intended as a substitute for adequate rest. You should NOT operate a vehicle if you are drowsy. During extended periods of vehicle operation, you should take frequent breaks. Improper reliance on the Stay Alert feature may result in vehicle damage, personal injury or death. **NEVER OPERATE A VEHICLE IF YOU ARE DROWSY.**

## SWS™

### Safety Warning System™

In communities where transmitters are located, the Safety Warning System™ displays over 60 text messages. When Safety Radar is detected the audio alert is geiger counter-like.

### Safety Warning System Text

Example: Poor - Road - Surface.

**NOTE:**  
Not all areas have Safety Warning System™ transmitters.

### Dual Alert Display D.A.D. (1776 only)

Whistler's new Dual Alert Display (DAD) feature provides added attention getting visual alert to the already Intense Blue Text Display. The two extra LED's in the display area flash on and off when the unit alarms to provide an unique visual alert. DAD can be programmed, through the Option Select Mode in three different ways: 1. to flash continuously through the alarm, 2. to flash for the first three seconds, or 3. turn flash off completely.